

Three spheres (two red, one white) are arranged in a triangular pattern. A red line starts from the left, goes up, then right, then down, ending in three arrows pointing towards the text.

**DIALAB**

**>>> DIAQUICK**  
**Rapid Tests**

[www.dialab.at](http://www.dialab.at)



## INTRODUCTION

DIAQUICK Rapid Tests are available for professional use for the following product groups:

<b>INFECTIOUS DISEASES</b> .....	page 3
<b>PREGNANCY / FERTILITY</b> .....	page 3
<b>TUMOR MARKERS</b> .....	page 3
<b>CARDIAC MARKERS</b> .....	page 3
<b>DIABETES</b> .....	page 3
<b>DRUGS OF ABUSE</b> .....	page 4

DIAQUICK Rapid Tests are qualitative (semi-quantitative) immunochromatographic tests. They are based on an antigen-antibody reaction, which can be visually interpreted via a colloidal gold conjugate that is used in the tests.

Rapid tests, which are specially certified for home use, are available for the detection of a pregnancy or for family planning (fertility test).

DIAQUICK Rapid Tests are easy to use and can be performed at any time or place and without the need of further instruments. DIAQUICK Rapid Tests can be performed with various types of sample material, depending on the test specifications: whole blood, serum, plasma or urine, saliva, sweat, solids and stool or swab samples.

## Features and Benefits

Nowadays, time and costs are important criteria for choosing the right test method. DIAQUICK Rapid Tests are easy to perform and provide qualitative or semi-quantitative results within a short time (5-10 min.). DIAQUICK Rapid Tests include a built-in quality control and are packed individually in a high quality foil pouch. All these features make the DIAQUICK Rapid Tests an ideal, cost effective tool to rapidly detect a wide variety of different parameters.

## Product Quality

All DIAQUICK Rapid Tests undergo a quality control by DIALAB on a regular basis. All rapid tests, which are available in the EU, are CE marked.

## Available Test Formats

DIAQUICK Rapid Tests are available in the following formats:

**Cassette**



**Multi-Panel**



**Dipstick**



**Saliva and Touch Test**



**Multi-Cup**





## PRODUCT RANGE

### INFECTIOUS DISEASES

TESTS  certified	WHOLE BLOOD	SERUM/ PLASMA	SWAB	STOOL	DIPSTICK	CASSETTE
Helicobacter pylori Ab	✓	✓	-	-	-	✓
Helicobacter pylori Ag	-	-	-	✓	-	✓
Mononucleosis (IM ) Ab	✓	✓	-	-	-	✓
Strep.A Ag	-	-	✓	-	✓	✓
Syphilis Ab	✓	✓	-	-	-	✓
Dengue Ab	✓	✓	-	-	-	✓
Chlamydia trachomatis Ag	-	-	✓	-	-	✓
H5 AIV Ag	-	-	✓	✓	-	✓
Strep.B Ag	-	-	✓	-	-	✓

TESTS for export outside the EU	WHOLE BLOOD	SERUM/ PLASMA	SWAB	STOOL	DIPSTICK	CASSETTE
HBs Ag (Hepatitis B s Ag)	a	✓	-	-	✓	✓
HBs Ab (Hepatitis B s Ab)	-	✓	-	-	✓	✓
HCV Ab (Hepatitis C)	✓	✓	-	-	-	✓
HIV Ab (HIV 1 and HIV 2)	✓	✓	-	-	-	✓
HIV Triline (HIV 1, 2 and O)	✓	✓	-	-	-	✓
Malaria P.falciparum Ag	✓	-	-	-	-	✓

### PREGNANCY / FERTILITY

TESTS  certified	URINE	WHOLE BLOOD	SERUM/ PLASMA	SWAB	DIPSTICK	CASSETTE
hCG (chorionic gonadotropin)	✓	-	-	-	✓	✓
hCG Combo	✓	-	✓	-	✓	✓
hCG Home-Test	✓	-	-	-	✓	-
LH (luteinising hormone)	✓	-	-	-	✓	✓
LH Home-Test	✓	-	-	-	✓	✓

### TUMOR MARKERS

TESTS  certified	URINE	WHOLE BLOOD	SERUM/ PLASMA	STOOL	DIPSTICK	CASSETTE
AFP (alpha fetoprotein)	-	✓	✓	-	-	✓
FOB (fecal occult blood)	-	-	-	✓	-	✓

TESTS for export outside the EU	WHOLE BLOOD	SERUM/ PLASMA	SWAB	STOOL	DIPSTICK	CASSETTE
CEA (carcinoembryonic antigen)	✓	✓	-	-	-	✓
PSA (prostate specific antigen)	-	✓	-	-	-	✓

### CARDIAC MARKERS

TESTS  certified	WHOLE BLOOD	SERUM/ PLASMA	SWAB	STOOL	DIPSTICK	CASSETTE
Troponin I	✓	✓	-	-	-	✓
CRP (C-reactive protein)	✓	-	-	-	✓	-
Myoglobin/CK-MB/Troponin I	✓	✓	-	-	-	✓

### DIABETES

TESTS  certified	URINE	WHOLE BLOOD	SERUM/ PLASMA	SWAB	DIPSTICK	CASSETTE
Microalbumin	✓	-	-	-	✓	-





## DRUGS OF ABUSE certified

### >> Drug detection in urine\*

PARAMETER		DETECTION LIMIT	DIPSTICK	CASSETTE	MULTI-PANEL
AMP	Amphetamine	1.000 ng/ml	✓	✓	✓
BAR	Barbiturate	300 ng/ml	✓	✓	✓
BZO	Benzodiazepine	300 ng/ml	✓	✓	✓
BUP	Buprenorphine	10 ng/ml	-	✓	✓
MDMA	Ecstasy	500 ng/ml	✓	✓	✓
THC	Marihuana	50 ng/ml	✓	✓	✓
COC	Cocaine	300 ng/ml	✓	✓	✓
MET	Methamphetamine	1.000 ng/ml	✓	✓	✓
MTD	Methadone	300 ng/ml	✓	✓	✓
MOP	Morphine/Opiate/Heroin	300 ng/ml	✓	✓	✓
OPI	Morphine/Opiate/Heroin	2.000 ng/ml	-	✓	✓
OXY	Oxycodone	100 ng/ml	-	✓	-
PCP	Phencyclidine	25 ng/ml	✓	-	✓
PPX	Propoxyphene	300 ng/ml	-	✓	-
TCA	Tricyclic Antidepressants	1.000 ng/ml	✓	✓	✓

### >> Detection of traces of drugs\* *for testing surfaces, solids and liquids*

PRODUCT	PARAMETER	DIPSTICK	CASSETTE	MULTI-PANEL
DOA Multi-6 High Sensitivity Touch Test	AMP, COC, THC, MET, MOP, PCP	-	-	✓
DOA Amphetamine Touch Test	AMP	✓	✓	-
DOA Cocaine Touch Test	COC	✓	✓	-
DOA Methamphetamine Touch Test	MET	✓	✓	-
DOA Morphine Touch Test	MOP	✓	✓	-

### >> Drug adulteration test

PRODUCT	PARAMETER
Drug Adulteration Strip-6	Creatinine, Nitrite, Glutaraldehyde, pH, Specific Gravity, Oxidants

### >> DOA Multi-Cup urine test *with integrated temperature control*

PRODUCT	PARAMETER
DOA Multi-6 Cup*	AMP, MET, BZO, COC, MOP, THC

### >> Drug detection in saliva

PRODUCT	PARAMETER
Alcohol Saliva Strips	0.02-0.30% blood alcohol concentration
DOA Saliva Multi-6 Test*	AMP, COC, THC, MET, MOP, PCP

\*Please refer also to the cut-off table at page 5.



## Cut-Off values for all DOA Cassettes, Dipsticks, Multi-Panels, Multi-Cups and Single Touch Tests:

<b>AMPHETAMINE AMP</b>		<b>1.000 ng/ml</b>	<b>OPIATE/MORPHINE MOP</b>		<b>300 ng/ml</b>
d-Amphetamine		1.000ng/ml	Morphine		300ng/ml
l-Amphetamine		50.000ng/ml	Codein		300ng/ml
d,l-Amphetamine		3.000ng/ml	Ethylmorphine		6.250ng/ml
Phentermine		3.000ng/ml	Hydrocodone		50.000ng/ml
3,4-Methylenedioxyamphetamine (MDA)		2.000ng/ml	Hydromorphone		3.125ng/ml
			Levorphanol		1.500ng/ml
<b>BENZODIAZEPINE BZO</b>		<b>300 ng/ml</b>	6-Monoacetylmorphine		400ng/ml
Oxazepam		300ng/ml	Morphine-3-glucuronide		1.000ng/ml
Alprazolam		196ng/ml	Norcodeine		6.250ng/ml
α-Hydroxyalprazolam		1.262ng/ml	Normorphine		100.000ng/ml
Bromazepam		1.562ng/ml	Oxycodone		30.000ng/ml
Chlordiazepoxide		1.562ng/ml	Oxymorphone		100.000ng/ml
Clobazam		98ng/ml	Procaine		15.000ng/ml
Clonazepam		781ng/ml	Thebaine		6.250ng/ml
Clorazepate		195ng/ml			
Delorazepam		1.562ng/ml	<b>OPIATE/MORPHINE OPI</b>		<b>2.000 ng/ml</b>
Desalkylflurazepam		390ng/ml	Morphine		2.000ng/ml
Diazepam		195ng/ml	Codeine		2.000ng/ml
Estazolam		2.500ng/ml	Ethylmorphine		5.000ng/ml
Flunitrazepam		390ng/ml	Hydrocodone		12.500ng/ml
Flurazepam		300ng/ml	Hydromorphone		5.000ng/ml
d,l-Lorazepam		1.562ng/ml	Levorphanol		75.000ng/ml
RS-Lorazepam-glucuronide		156ng/ml	6-Monoacetylmorphine		5.000ng/ml
Midazolam		12.500ng/ml	Morphine-3-glucuronide		2.000ng/ml
Nitrazepam		98ng/ml	Norcodeine		12.500ng/ml
Norchlordiazepoxide		195ng/ml	Normorphine		50.000ng/ml
Nordiazepam		390ng/ml	Oxycodone		25.000ng/ml
Temazepam		98ng/ml	Oxymorphone		25.000ng/ml
Triazolam		2.500ng/ml	Procaine		150.000ng/ml
			Thebaine		100.000ng/ml
<b>BARBITURATE BAR</b>		<b>300 ng/ml</b>	<b>METHADONE MTD</b>		<b>300 ng/ml</b>
Secobarbital		300ng/ml	Methadone		300ng/ml
Alphenol		150ng/ml	Doxylamine		50.000ng/ml
Amobarbital		300ng/ml			
Aprobarbital		200ng/ml	<b>PHENCYCLIDINE PCP</b>		<b>25 ng/ml</b>
Butabarbital		75ng/ml	Phencyclidine		25ng/ml
Butalbital		2.500ng/ml	4-Hydroxy-phencyclidine		12,500ng/ml
Butethal		600ng/ml			
Cyclopentobarbital		100ng/ml	<b>TETRAHYDROCANNABINOL THC</b>		<b>50 ng/ml</b>
Pentobarbital		300ng/ml	11-nor-Δ <sup>9</sup> -tetrahydrocannabinol-9 COOH		30ng/ml
Phenobarbital		100ng/ml	11-nor-Δ <sup>9</sup> -tetrahydrocannabinol-9 COOH		50ng/ml
			Δ <sup>8</sup> THC		15.000ng/ml
<b>COCAINE COC</b>		<b>300 ng/ml</b>	Δ <sup>9</sup> THC		15.000ng/ml
Cocaine		780ng/ml	Cannabinol		20.00ng/ml
Benzoylcegonine		300ng/ml	Cannabidiol		100.000ng/ml
Cocaethylene		12.500ng/ml			
Ecgonine		32.000ng/ml	<b>TRICYCLIC ANTIDEPRESSANTS TCA</b>		<b>1.000 ng/ml</b>
<b>ECSTASY MDMA</b>		<b>500 ng/ml</b>	Nortriptyline		1.000ng/ml
(+/-)-3,4-Methylenedioxymethamphetamine		500ng/ml	Amitriptyline		1.500ng/ml
(+/-)-3,4-Methylenedioxyamphetamine		3.000ng/ml	Desipramine		200ng/ml
3,4-Methylenedioxyethylamphetamine		300ng/ml	Imipramine		400ng/ml
			Nordoxepine		1.000ng/ml
<b>METAMPHETAMINE MET</b>		<b>1.000 ng/ml</b>	Clomipramine		12.500ng/ml
d-Methamphetamine		1.000ng/ml	Doxepine		2.000ng/ml
l-Methamphetamine		8.000ng/ml	Promazine		1.500ng/ml
(+/-)-3,4-Methylenedioxymethamphetamine		2.000ng/ml	Trimipramine		3.000ng/ml
Mephentermine		50.000ng/ml	Maprotiline		2.000ng/ml
			Promethazine		75.000ng/ml
<b>OXYCODONE OXY</b>		<b>100 ng/ml</b>	Trimipramine		3.000ng/ml
Oxycodone		100ng/ml			
Codeine		50.000ng/ml	<b>PROPOXYPHEN PPX</b>		<b>300 ng/ml</b>
Dihydrocodeine		12.500ng/ml	D-Propoxyphen		300ng/ml
Ethylmorphine		25.000ng/ml	D-Norpropoxyphen		300ng/ml
Hydrocodone		562ng/ml			
Hydromorphone		12.500ng/ml			
Oxymorphone		1562ng/ml			
Thebaine		50.000ng/ml			

## Cut-off values for DOA Saliva Multi-6 and DOA Multi-6 High Sensitivity Touch Test:

SUBSTANCE	CONCENTRATION	SUBSTANCE	CONCENTRATION
Amphetamine AMP	50 ng/ml	Methamphetamine MET	50 ng/ml
Morphine MOP	40 ng/ml	Cocaine COC	20 ng/ml
Phencyclidine PCP	10 ng/ml	Marihuana THC	12 ng/ml





## ASSAY PROCEDURES

### ASSAY PROCEDURE: URINE TESTS

#### >> DIPSTICKS



- Open the foil pouch by tearing along the notch and remove the dipstick.
- With arrows pointing towards the urine specimen, dip the stick in the urine specimen for 10-15 seconds submerging only up to the MAX mark.
- Place the dipstick on a non-absorbent flat surface, then start the timer.
- Wait for the red line(s) to appear.

#### >> CASSETTES



- Open the foil pouch by tearing along the notch and remove the test cassette.
- Place the cassette on a clean and level surface. Aspirate some urine sample with the provided dropper.
- Hold the dropper vertically and transfer 3 full drops of urine (approx. 100 µl) to the specimen well (S) of the test cassette, then start the timer. Avoid trapping air bubbles in the specimen well.
- Wait for the red line(s) to appear.

#### >> MULTI-PANELS



- Open the foil pouch by tearing along the notch and remove the drug panel.
- Take off the protective cap plugged on the test panel.
- With arrows pointing towards the urine specimen, immerse the drug panel vertically into the urine specimen for 10-15 seconds submerging only up to the MAX mark.
- Place the panel on a non-absorbent flat surface and start the timer.
- Wait for the red line(s) to appear.

#### >> MULTI-CUP

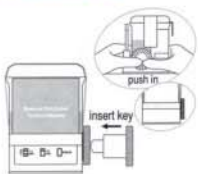

- Open the foil pouch by tearing along the notch and remove the cup.
- Remove the key by twisting it from the center of the cup cap.
- Collect specimen in the cup and secure the cap tightly by pressing down on the pull tab until an audible click is heard.
- Check the temperature label up to 4 minutes after specimen collection. A green color will appear to indicate the temperature of the urine specimen.
- Place the cup on a flat surface and push the key into the socket of the cup to initiate the test. Start the timer.
- Remove the peel off label covering the test results and wait for the colored line(s) to appear.

**IMPORTANT:** Read the results after 5 minutes. After more than 10 minutes the results are invalid and must not be interpreted any more.

### ASSAY PROCEDURE: WHOLE BLOOD TESTS

#### >> DIPSTICKS

- Take a drop of blood (10 µl) by using the provided capillary pipette.
- Put the blood-filled capillary pipette in the provided tube filled with buffer and mix vigorously.
- Open the foil pouch by tearing along the notch and remove the dipstick.
- Put the dipstick into the liquid. Make sure, that the test is immersed only to the MAX mark.
- Leave the dipstick in the sample fluid for ~20 seconds, take out the dipstick and put it onto a flat, non-absorbent surface. Start the timer.
- Wait for the red line(s) to appear.

#### >> CASSETTES

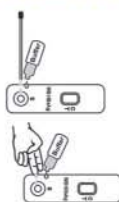

- Open the foil pouch by tearing along the notch and remove the test cassette.
- Place the test cassette on a clean and level surface.
- **To use a capillary tube:** Fill the capillary tube and transfer approximately 50 µl of fingerstick whole blood to the specimen well (S) of the test cassette, then add 1 drop of buffer (approximately 40 µl) and start the timer.
- **To use hanging drops:** Allow 2 hanging drops of fingerstick whole blood (approximately 50 µl) to fall into the center of the specimen well (S) on the test cassette, then add 1 drop of buffer (approximately 40 µl) and start the timer.
- Wait for the red line(s) to appear.

**IMPORTANT:** Read the results after 15 min. (CRP Dipstick 5 min.). After more than 20 min. the results are invalid and must not be interpreted any more.

### ASSAY PROCEDURE: TESTS FOR SERUM OR PLASMA

#### >> DIPSTICKS

- Open the foil pouch by tearing along the notch and remove the dipstick.
- With arrows pointing towards the serum or plasma specimen, dip the stick vertically in the serum or plasma for at least 10-15 seconds. Do not pass the MAX mark on the dipstick when immersing the strip.
- Place the dipstick on a non-absorbent flat surface and start the timer.
- Wait for the red line(s) to appear.

#### >> CASSETTES

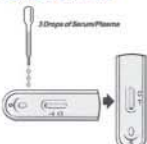

- Open the foil pouch by tearing along the notch and remove the test cassette.
- Place the cassette on a clean and level surface. Aspirate some serum or plasma sample with the provided dropper.
- Hold the dropper vertically and transfer 3 full drops of serum or plasma (approx. 75 µl) to the specimen well (S) of the test cassette, and then start the timer. Avoid trapping air bubbles in the specimen well (S).
- Wait for the red line(s) to appear.

**IMPORTANT:** Read the results after 15 min. After more than 20 min. the results are invalid and must not be interpreted any more.





## ASSAY PROCEDURE: TESTS FOR STOOL SAMPLES

### >> Sample preparation

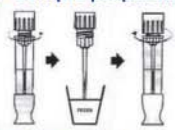

- Unscrew and remove the collection tube applicator stick. Collect random samples by using the applicator stick. Take samples from different areas of the faeces specimen.
- Re-insert the applicator stick into the tube and screw the cap tightly.
- Shake the collection tube thoroughly to ensure proper mixing of the fecal sample with the extraction solution.

### >> Test procedure

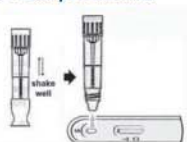

- Open the foil pouch by tearing along the notch and remove the test cassette.
- Use the tip of the collection tube to add 3 full drops (approx. 120 µl) of solution into the sample well of the test cassette. Start the timer.
- Wait for the colored line(s) to appear. Results should be read after 5 min. for the FOB test and after 10 min. for the H.pylori Stool test

The testing of stool samples is a preferable way for the testing of H.pylori, as classical detection methods such as an endoscopy of the gastric mucosa or breath tests, are often complicated, painful, expensive and require a long time. The DIAQUICK H. pylori Stool Cassette is an immunological rapid assay, which is easy to use and takes advantage of a highly specific antibody/antigen reaction to qualitatively detect H. pylori antigen in stool samples.

## ASSAY PROCEDURE: TESTS FOR SWAB SAMPLES

### >> Sample preparation

#### Throat swabs

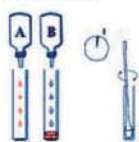

- Add 4 full drops of reagent A to an extraction test tube, then add 4 full drops of reagent B. Mix the solution by gentle swirling. The addition of reagent B to reagent A changes the color of the solution from red to pale yellow.
- Immediately add the swab into the prepared solution. Stir the liquid with the swab, thus enabling good separation of the swabbed material from the swab. Leave the swab in the tube for up to 1 min. (Strep.B 3-5 min.). Press the swab firmly against the tube in order to squeeze out as much liquid as possible.

#### Endocervical or urethral swabs

- Place a clean extraction tube into the plastic holder. Add 5 drops of solution A to the tube.
- Immerse the patient's swab in the tube and extract for 2 min. at room temperature. During extraction, stir the liquid with the swab, thus enabling good separation of the swabbed material from the swab.
- At the end of the extraction time, add 5 drops of solution B and mix the solution with the swab. Press the swab firmly against the tube in order to squeeze out as much liquid as possible.
- The specimens extracted can be kept at room temperature for 60 minutes.

### >> Test procedure

- Open the foil pouch by tearing along the notch and remove the test cassette.
- Put the dropper cap on the extraction tube. Place the test cassette on a clean and level surface. Add 3 full drops of the solution to the specimen well (S) of the cassette and then start the timer.
- Wait for the colored lines to line(s) to appear. Read the result at 5 minutes (Chlamydia 15 min.).

## ASSAY PROCEDURE: TESTING OF SOLIDS AND SWEAT

### >> Sample preparation

#### Powders, Surfaces

- Moisten the sponge of the collector with Touch Test Buffer.
- The sponge is dipped into the substance to be tested or wiped on any suspicious surface.
- Press the sponge against the strainer. Mix by shaking vigorously.

#### Solids, Tablets

- Transfer a little amount of suspicious material into the collection tube.
- Mix by shaking vigorously.

#### Skin, Sweat

- Apply the provided Skin and Sweat Solvent on the sponge of the collector.
- Wipe on skin or sweat.
- Press the sponge against the strainer. Mix by shaking vigorously.

#### Liquids

- Use a pipette to soak up some drops of the liquid to be tested.
- Transfer 3 drops of the sample into the collection tube and mix by shaking vigorously.

### >> Test procedure



- Open the foil pouch by tearing along the notch and remove the test cassette.
- Add 3 drops of the prepared sample in the collection tube to each specimen well (S) of the cassette and start the timer.
- Wait for the colored line(s) to appear. Read the results after 5 minutes.

## ASSAY PROCEDURE: SALIVA TESTS

### >> Sample preparation



- Using the provided oral fluid swab, sweep the inside of the mouth for 3 minutes.
- Stop sweeping the mouth and push the moistened swab firmly into the collection tube to release as much liquid as possible.
- Tightly shut the outer cap of the specimen dispenser.

### >> Test procedure



- Open the foil pouch by tearing along the notch and remove the test cassette.
- Place the test on a clean, level surface and label with patient identification.
- Unscrew the dispensing tip of the collection tube transfer 3-4 drops of fluid (approx. 180 µl) to each specimen well (S) of the cassette and start the timer.
- Wait for the colored line(s) to appear. Read the results after 10 min.





## TEST RESULTS

### COMPETITIVE TESTS

#### DRUGS OF ABUSE AND MICROALBUMIN TESTS

The results should be interpreted after the time stated in the package insert. Do not wait too long, as this could lead to invalid test results.

The intensity of the test lines (T) can vary, but even a faint test line should be regarded as a negative test result.

##### Negative result:

Two distinct red lines appear. One line should be in the control region (C), and another line should be in the test region (T).

##### Positive result:

One red line appears in the control region (C). No line appears in the test region (T).

##### Invalid result:

Control line fails to appear. Insufficient specimen volume or incorrect procedural techniques are the most likely reasons for control line failure.

### TEST RESULTS COMPETITIVE TESTS

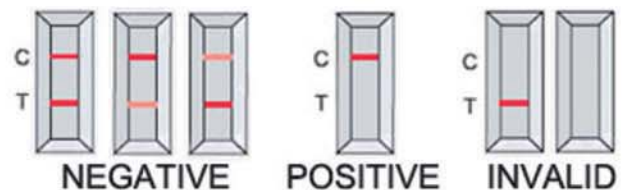

### SANDWICH TESTS

#### ALL TESTS EXCEPT DRUGS OF ABUSE AND MICROALBUMIN

The results should be interpreted after the time stated in the package insert. Do not wait too long, as this could lead to invalid test results.

The intensity of the test lines (T) can vary, but even a faint test line should be regarded as a positive test result.

##### Negative result:

One red line appears in the control region (C). No line appears in the test region (T).

##### Positive result:

Two distinct red lines appear. One line should be in the control region (C) and another line should be in the test region (T).

##### Invalid result:

Control line fails to appear. Insufficient specimen volume or incorrect procedural techniques are the most likely reasons for control line failure.

### TEST RESULTS SANDWICH TESTS

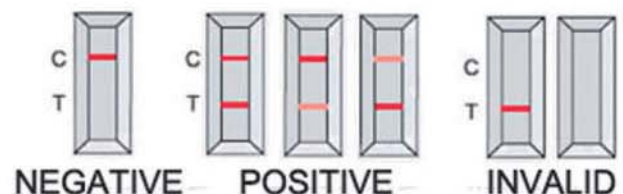

## OEM / BULK

A lot of products listed in our catalogue are also available in bulk and OEM version (neutral, single packed tests without further packaging). For special requests or further information regarding "Bulk Products and Customized Kits" please contact us.

## STORAGE AND STABILITY

DIAQUICK Tests may be stored at room temperature or refrigerated and have a shelf life of 24 months from date of production. All DIAQUICK Rapid Tests are packed individually in a high quality foil pouch together with a desiccant. The tests are stable until the date printed on the pouch. As rapid tests contain biological agents like antibodies and antigens, the degradation of these tests is temperature sensitive. For long term storage and during transportation it is recommended to store all DIAQUICK Rapid Tests at cool places avoiding extreme temperature conditions and direct sunlight.

When stored in the refrigerator at 2-8°C please be aware to let the tests equilibrate to room temperature before testing. Otherwise moisture will accumulate on the test membrane, which may disturb the test.





## DIALAB HOME TESTS

DIALAB offers special tests for home use. Currently, the following tests are available:

### DIAQUICK Pregnancy Test:

- for the detection of the pregnancy hormone hCG in urine
- available in dipstick format

### DIAQUICK Fertility Test:

- for the detection of the ovulation hormone hLH in urine
- available in dipstick and cassette format



## DIALAB HOME TESTS CAN BE USED BY EVERYONE!

All DIALAB Home Tests are specially CE certified by the TÜV Austria for Home Use and Self Testing.

The tests are easy to use and contain user friendly package inserts in multiple languages: English, Spanish, Turkish, German, French, Italian, Czech, Hungarian, Serbian, Polish, Greek and Russian. Furthermore, the package inserts are complete with self-explanatory illustrations, so they can be used without further instructions directly by the endusers.

All these points make the DIALAB Home Tests ideal for selling them not only in specialised trade, but also in pharmacies, drug stores, supermarkets etc.!

## DIAQUICK PREGNANCY TEST

The DIAQUICK Pregnancy Test is a rapid, one-step lateral flow immunoassay for the qualitative detection of human Chorionic Gonadotropin (hCG) in urine to aid in the detection of pregnancy. The test utilizes a combination of antibodies including a monoclonal hCG antibody to selectively detect elevated levels of hCG. The assay is conducted by immersing the end of the dipstick into the urine sample. The results are obtained from the colored lines appearing in the result window.

## DIAQUICK FERTILITY TEST

The DIAQUICK Fertility Test is a rapid, one-step lateral flow immunoassay for the qualitative detection of LH surges in urine, signalling that ovulation is likely to occur in the next 24-36 hours. The test utilizes a combination of antibodies including a monoclonal LH antibody to selectively detect elevated levels of LH. The assay is performed by immersing the end of the strip into the urine sample when using the dipstick format or by applying a sample to the sample well of the cassette with the provided dropper pipette. The results are obtained from the colored lines appearing in the result window.





## ORDERING INFORMATION

### INFECTIOUS DISEASES *sandwich tests*

PRODUCT	PACKAGE	CAT. NR.	PACKAGE	CAT.NR.
H. PYLORI-CASSETTE	30 Tests	Z06229CE		
MONONUCLEOSIS-CASSETTE	30 Tests	Z06620CE		
STREP.A-CASSETTE	20 Tests	Z98223CE		
STREP.A-DIPSTICK	20 Tests	Z98230CE		
SYPHILIS AB-CASSETTE	30 Tests	Z06903CE		
CHLAMYDIA CASSETTE	20 Tests	Z98226CE		
DENGUE AB-CASSETTE	30 Tests	Z06240		
STREP.B-CASSETTE	20 Tests	Z08025CE		
H5 AIV CASSETTE	10 Tests	Z06800CE		
H.PYLORI STOOL-CASSETTE	20 Tests	Z08090CE	5 Tests	Z08091CE
<b>PRODUCT for export outside the EU</b>	<b>PACKAGE</b>	<b>CAT.NR.</b>	<b>PACKAGE</b>	<b>CAT.NR.</b>
HBsAB-CASSETTE	30 Tests	Z98239		
HBsAB-DIPSTICK	30 Tests	Z03232		
HBsAG-CASSETTE (serum/plasma)	30 Tests	Z00350		
HBsAG-CASSETTE (whole blood/serum/plasma)	30 Tests	Z06351		
HBsAG-DIPSTICK (5 mm)	30 Tests	Z98224		
HBsAG-DIPSTICK (3 mm)	30 Tests	Z04225		
HCV-CASSETTE (serum/plasma)	30 Tests	W06100		
HCV-CASSETTE (whole blood/serum/plasma)	30 Tests	W06101		
HIV TRILINE-CASSETTE	30 Tests	W06112		
HIV-CASSETTE (serum/plasma)	30 Tests	W06110		
HIV-CASSETTE (whole blood/serum/plasma)	30 Tests	W06111		
MALARIA P.FALCIPARUM-CASSETTE	30 Tests	W06200		

### PREGNANCY / FERTILITY *sandwich tests*

PRODUCT	PACKAGE	CAT.NR.	PACKAGE	CAT.NR.
hCG-CASSETTE	30 Tests	Z98404CE	10 Tests	Z07201CE
hCG-DIPSTICK (5mm)	30 Tests	J01402-1CE	10 Tests	Z07202-1CE
hCG-DIPSTICK (3mm)	30 Tests	J01402-2CE	10 Tests	Z07202-2CE
hCG COMBO-CASSETTE	30 Tests	Z01405CE	10 Tests	Z07101CE
hCG COMBO-DIPSTICK (5mm)	30 Tests	Z03403-1CE	10 Tests	Z07102-1CE
hCG COMBO-DIPSTICK (3mm)	30 Tests	Z03403-2CE	10 Tests	Z07102-2CE
LH-CASSETTE	30 Tests	Z98502CE	10 Tests	Z07301CE
LH-DIPSTICK	30 Tests	Z06507CE	10 Tests	Z07302CE
hCG PREGNANCY TEST for home use	1 Test	Z05305DL		
LH FERTILITY TEST Dipstick for home use	5 Tests	Z05511		
LH FERTILITY TEST Cassette for home use	5 Tests	Z05515		

### TUMOR MARKERS *sandwich tests*

PRODUCT	PACKAGE	CAT.NR.	PACKAGE	CAT.NR.
AFP CASSETTE	30 Tests	Z06020CE		
FOB CASSETTE	25 Tests	Z01101CE	5 Tests	Z01102CE
<b>PRODUCT for export outside the EU</b>	<b>PACKAGE</b>	<b>CAT.NR.</b>	<b>PACKAGE</b>	<b>CAT.NR.</b>
PSA CASSETTE	30 Tests	Z08010		
CEA CASSETTE	30 Tests	Z06030		

### CARDIAC MARKERS *sandwich tests*

PRODUCT	PACKAGE	CAT.NR.	PACKAGE	CAT.NR.
TROPONIN I CASSETTE	30 Tests	Z08120CE	5 Tests	Z08125CE
CRP DIPSTICK	20 Tests	Z08026CE	5 Tests	Z08025CE
MYOGLOBIN/CK-MB/TROPONIN I CASSETTE	5 Tests	Z08233CE		

### DIABETES *competitive tests*

PRODUCT	PACKAGE	CAT.NR.	PACKAGE	CAT.NR.
MICROALBUMIN CASSETTE	20 Tests	Z08070CE	5 Tests	Z08071CE





## DRUGS OF ABUSE *competitive tests* certified

### >> Drug detection in urine

#### Cassettes and Dipsticks

PRODUCT	PACKAGE	CAT.NR.	PACKAGE	CAT.NR.
AMP-CASSETTE	30 Tests	Z99004CE	10 Tests	Z07401CE
AMP-DIPSTICK	30 Tests	Z02504CE	10 Tests	Z07501CE
BAR-CASSETTE	30 Tests	Z99006CE	10 Tests	Z07402CE
BAR-DIPSTICK	30 Tests	Z02506CE	10 Tests	Z07502CE
BZO-CASSETTE	30 Tests	Z99001CE	10 Tests	Z07404CE
BZO-DIPSTICK	30 Tests	Z02501CE	10 Tests	Z07504CE
BUP-CASSETTE	30 Tests	Z04560CE	10 Tests	Z07403CE
COC-CASSETTE	30 Tests	Z99003CE	10 Tests	Z07405CE
COC-DIPSTICK	30 Tests	Z02510CE	10 Tests	Z07505CE
THC-CASSETTE	30 Tests	Z99002CE	10 Tests	Z07413CE
THC-DIPSTICK	30 Tests	Z02502CE	10 Tests	Z07513CE
MDMA-CASSETTE	30 Tests	Z04570CE	10 Tests	Z07406CE
MDMA-DIPSTICK	30 Tests	Z05610CE	10 Tests	Z07506CE
MET-CASSETTE	30 Tests	Z99500CE	10 Tests	Z7407CE
MET-DIPSTICK	30 Tests	Z02500CE	10 Tests	Z07507CE
MTD-CASSETTE	30 Tests	Z99550CE	10 Tests	Z07409CE
MTD-DIPSTICK	30 Tests	Z02550CE	10 Tests	Z07509CE
MOP-CASSETTE	30 Tests	Z99005CE	10 Tests	Z07408CE
MOP-DIPSTICK	30 Tests	Z02505CE	10 Tests	Z07508CE
OPI-CASSETTE	30 Tests	Z05011CE	10 Tests	Z07410CE
OXY-CASSETTE	30 Tests	Z06007CE	10 Tests	Z06010CE
PCP-DIPSTICK	30 Tests	Z02560CE	10 Tests	Z07411CE
PPX-CASSETTE	30 Tests	Z06008CE	10 Tests	Z06009CE
TCA-CASSETTE	30 Tests	Z03040CE	10 Tests	Z07412CE
TCA-DIPSTICK	30 Tests	Z05045CE	10 Tests	Z07512CE

#### Multi-Panels

PRODUCT	PARAMETER	PACKAGE	CAT.NR.	PACKAGE	CAT.NR.
MULTI-3	MOP,COC,BZO	30 Tests	Z06576CE	10 Tests	Z07601CE
MULTI-4	MOP,COC,THC,AMP	30 Tests	Z02575CE	10 Tests	Z07602CE
MULTI-5/3	MOP,COC,MET,AMP,THC	30 Tests	Z06502CE	10 Tests	Z07607CE
MULTI-5/6	MOP,COC,AMP,BZO,THC	30 Tests	Z06506CE	10 Tests	Z07608CE
MULTI-6	MOP,MTD,MET,BZO,COC,THC	30 Tests	Z98907CE	10 Tests	Z07603CE
MULTI-6/1	MOP,AMP,MET,BZO,COC,THC	30 Tests	Z03220CE	10 Tests	Z07604CE
MULTI-10	MOP,AMP,MET,MDMA,COC,BAR,BZO,MTD,TCA,THC	30 Tests	Z06230CE	10 Tests	Z04231CE
MULTI-10/1	MOP,BUP,AMP,MET,MDMA,COC,BAR,BZO,MTD,THC	30 Tests	Z06235CE	10 Tests	Z06236CE
MULTI-10/2	MOP,AMP,BZO,THC,COC,MTD OPI,BAR,MDMA,TCA	30 Tests	Z06102CE		
MULTI-10/3	MOP,AMP,BZO,THC,COC,MTD,OPI,MDMA,TCA,PCP	30 Tests	Z06103CE		
MULTI-10/4	AMP,BZO,THC,COC,MTD,OPI,BAR,MDMA,MET,BUP	30 Tests	Z06104CE	10 Tests	Z07605CE
MULTI-10/5	MOP,AMP,BZO,THC,COC,MTD,BAR,MET,TCA,BUP	30 Tests	Z06105CE	10 Tests	Z07606CE
MULTI-10/6	MOP,AMP,BZO,THC,COC,MTD,BAR,MET,TCA,PCP	30 Tests	Z06106CE		
MULTI-10/7	AMP,BZO,THC,COC,MTD,OPI,BAR,MET,TCA,PCP	30 Tests	Z06107CE		

### >> Detection of traces of drugs *for testing surfaces, solids and liquids*

PRODUCT	PARAMETER	PACKAGE	CAT. NR.
Multi-6 High Sensitivity Touch Test	AMP,COC,THC,MET,MOP,PCP	25 Tests	Z05585
AMP Touch Test	AMP	10 Tests	Z06589
COC Touch Test	COC	10 Tests	Z06587
MET Touch Test	MET	10 Tests	Z06588
MOP Touch Test	MOP	10 Tests	Z06590

### >> Drug adulteration tests

PRODUCT	PARAMETER	PACKAGE	CAT.NR.
Drug Adulteration Strip-6	Creatinine, Nitrite, Glutaraldehyde, pH, Specific Gravity, Oxidants	1 Test	Z06667

### >> DOA Multi-Cup urine test *with integrated temperature control*

PRODUCT	PARAMETER	PACKAGE	CAT.NR.
DOA Multi-6 Cup	AMP, MET, BZO, COC, MOP, THC	1 Test	Z06667

### >> Drug detection in saliva

PRODUCT	PARAMETER	PACKAGE	CAT.NR.
Alcohol Saliva Strips	0.02-0.30% blood alcohol concentration	25 Tests	Z06677CE
DOA Saliva Multi-6 Test	AMP, COC, THC, MET, MOP, PCP	25 Tests	Z04580CE



**Head Office: Austria**

A-2351 Wr. Neudorf Austria  
IZ-NÖ Süd

Hondastrasse, Objekt M55

Phone: ++43(0)2236 660910-0

Fax: ++43(0)2236 660910-30

e-mail: [office@dialab.at](mailto:office@dialab.at)

[www.dialab.at](http://www.dialab.at)

**Hungary**

**DIALAB® KFT**

Pasaréti út 31, H-1026 Budapest

Phone: ++36-1-212 25 05

Fax: ++36-1-355 73 70

e-mail: [dialab@mail.datanet.hu](mailto:dialab@mail.datanet.hu)

[www.dialab.hu](http://www.dialab.hu)

**DIALAB® Produktion und Vertrieb  
von chemisch-technischen Produkten  
und Laborinstrumenten Gesellschaft m.b.H.**

**Czech Republic**

**DIALAB® SPOL.SR.O.**

Namesti Osvoboditelu 1, CZ-153 00 Prague 5 Radotín

Phone/Fax: ++420-2-579 10 255

e-mail: [office@dialab.cz](mailto:office@dialab.cz)

[www.dialab.cz](http://www.dialab.cz)

**Serbia**

**DIALAB® Export - Import D.o.o.**

Carigradska 1

11 008 Belgrade 12

Serbia

Phone: ++381-11-32 38 745

Phone/Fax: ++381-11-32 42 777

e-mail: [dialab@sbb.co.yu](mailto:dialab@sbb.co.yu)

DIALAB® reserves the right to change specifications without prior notice as part of our continuous product improvement

**[www.dialab.at](http://www.dialab.at)**